

E-316C Series Relay, Undervoltage AC 3 Phase, Lowest of 3

Product Facts

- DPDT
- Gasket sealed
- Meets many requirements of MIL-PRF-6106

Performance Data

Electrical Characteristics

Contact Arrangement — DPDT
Resistive Rating @ 28 Vdc — 10 Amps
Inductive Rating — 5 Amps
Lamp Load — 1.5 Amps
Rated Operating Voltage, Nom. — 115 V, 400 Hz
Pickup Voltage (All 3 Phases Up) — 85-90 Volts
Dropout Voltage (3 Phase Lowest of 3) — 75-80 Volts

General Characteristics

Temperature Range — -55°C to +71°C
Operating Cycles (Life) at Rated Resistive Load, Min. — 10,000 cycles
Weight, Max. — 10 oz.
Operating Voltage, Max. — 124 VAC

Circuit Configurations

(Consult factory for other available circuit configurations)

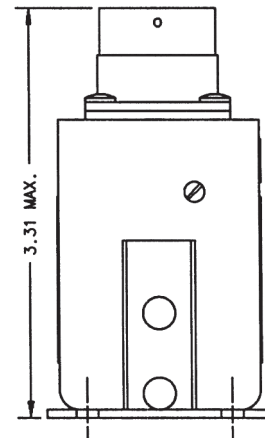
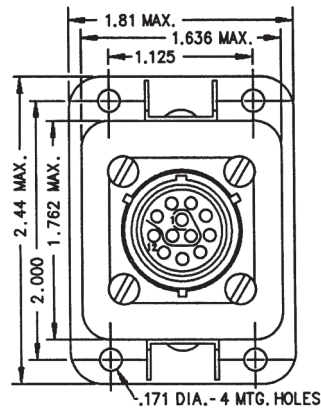
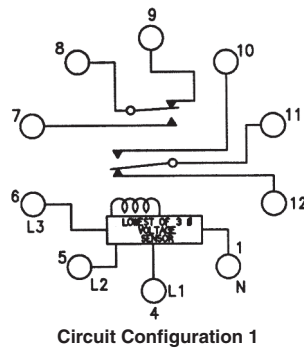

Mounting Style A

For factory-direct application assistance, phone 419-521-9500 or fax 419-526-2749.

HARTMAN Part Number	Construction Type	Mounting Style	Duty Cycle	Circuit Config.	TE Part Number
E-316C	Gasket/Vented	A	Continuous	1	1-1616126-4